



## **30 YEAR WARRANTY– VENT Roll Panel Vent**

Blue Building Solutions Ltd. t/a VENT warrants that the VENT Roll Panel Vent G502 supplied by VENT will retain their mechanical function for a period in excess of 30 years, under natural conditions, from the date of purchase. Provided the VENT Over Fascia Vents are installed in accordance Design & Specification Guides supplied by VENT.

VENT warrants the VENT Roll Panel Vents under the following terms & conditions:

- a. This warranty is given to consumers as defined in and who have the rights under the Consumer Guarantees Act 1993 and should be read with the statutory consumer guarantees contained in that Act.
- b. This warranty will apply to defects appearing within 30 years from the date of purchase & where notification of defects is received in writing within 28 Days of the defect appearing.
- c. Warranties will only be honoured if the VENT products in question were installed, used and maintained in accordance with VENT installation guides all of which are available on [www.eboss.co.nz](http://www.eboss.co.nz) and on the VENT website [www.vent.nz](http://www.vent.nz)
- d. Warranties will not apply to damage caused by external physical agents, accidental damage or other Force Majeure.
- e. The sole & exclusive remedy with regard to the above warranty is limited to the repair or supply of replacement profiles at VENTs discretion

This warranty shall be construed and interpreted in accordance with New Zealand Law and shall be subject to the jurisdiction of New Zealand Courts only.

This warranty does not affect the statutory rights of consumers.

# Control of Condensation in Buildings

## Product Information Sheet

### VENT Roll Panel Vent – G502

**Description** The G502 VENT Roll Panel Vent is designed to maintain a continuous 25mm air gap between the underside of the roofing membrane or sarking board and loft insulation at the eaves, providing a consistent flow of air into the roof space.

The castellated profile is laid across the top of the roof trusses/rafters parallel with the eaves level and is suitable for both new build and roof renovation projects. The extra width of the panel allows for better coverage when low pitch and deep insulation details are encountered.

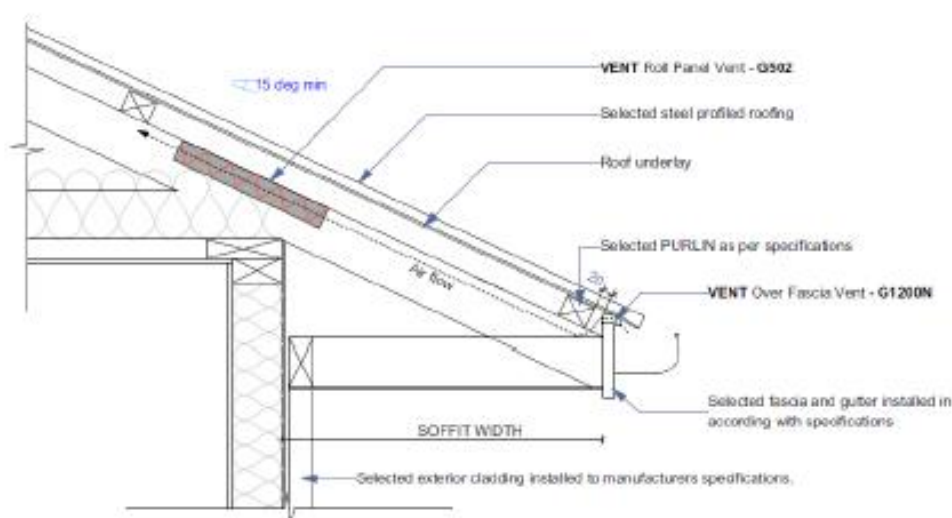
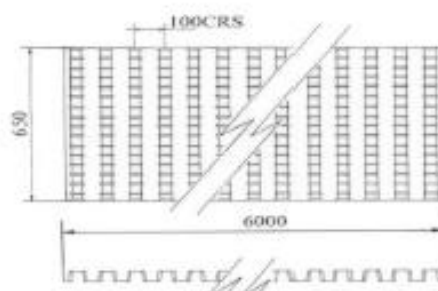

Fig A: Application on trussed roof

**Fixing** – The G502 VENT Roll Panel Ventilator (A) should be rolled out over the full length of the eaves and adjusted to align with the required roof truss centres then nailed or stapled to secure in position as shown.

This product should be used in conjunction with other soffit/fascia vents to provide a complete passive ventilation system.



Note: These diagrams are for guidance purposes only. The overall design is the responsibility of the designer as there are often other factors to consider.