

VENT APRON VENT

RV10P HALF

DESCRIPTION

The VENT Apron or Barge Vent is created by simply cutting the VENT Ridge Vent in half which creates the perfect ventilation product for both abutment and mono barge details. The vents enable warm air to escape from the lower roof void (Fig A) or as a barge vent for skillion mono pitch roof types (Fig B).

The RV10P Half has an adhesive and flexible aluminium flashing which is designed to form to most cladding profiles, preventing water ingress on any pitch roof.

FEATURES

- Free airflow of 8,000mm² per linear metre.
- Releases hot air from roof voids and eliminates condensation.
- Easy to install - manufactured in 1200mm lengths for easy handling.
- Not visible when covered with flashing (NB: flashing not included).
- Insect proof - 4mm vents prevent ingress of nesting insects.

SCOPE OF USE

- Compatible with roof cladding profiles with a trough depth of <34mm. For trough depths >34mm, an RV10DT Half (Deep Trough) should be used.
- Suitable for new builds or renovations.
- To be used as part of proprietary ventilation system.

APPRAISALS

- BRANZ appraisal No. 979 [2017].

WARRANTY

- 30 years.

MAINTENANCE

- No maintenance requirements.

INSTALLATION

1. The RV10P Half is placed over the top of the roof cladding.
2. The protective paper is removed from the underside of the flashing tape which is then moulded to the shape of the roof cladding.
3. Additional fixing screw length is required to accommodate 20mm thickness of the RV10P Half.
4. Remove all moisture and dust from the roof cladding before dressing down the aluminium soft edge.
5. The aluminium soft edge should be notched or snipped as required to suit the roofing profile. Notching or snipping is always required on Deep trough or trapezoidal roofing profiles.
6. Care should be taken when dressing down the aluminium soft edge. When dressing down the aluminium soft edge, start at the outer edge of the soft edge and work in towards the vent. Between 17mm and 25mm contact with the trough is required, depending on the cladding profile.
7. Minimum working temperature to dress down the soft edge flashing is +5°.
8. Soft edge flashing temperature resistance: -40° to +90°.
9. The apron or barge flashing sits over the top of the RV10P Half and fixed as shown in Figs A & B.
10. Standard ridge flashings of 200mm can be used to conceal soft edge of the ridge vent.
11. Compatibility of the RV10P Half and the chosen ridge capping system should be checked with the roofing manufacturer supplying the ridge capping.
12. For technical assistance contact the VENT technical team.



VENT APRON VENT RV10P HALF

Fig A: Skillion Roof Abutment Application

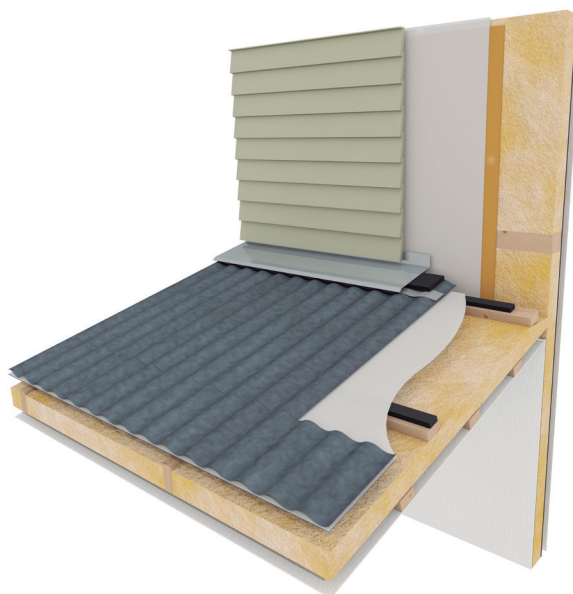
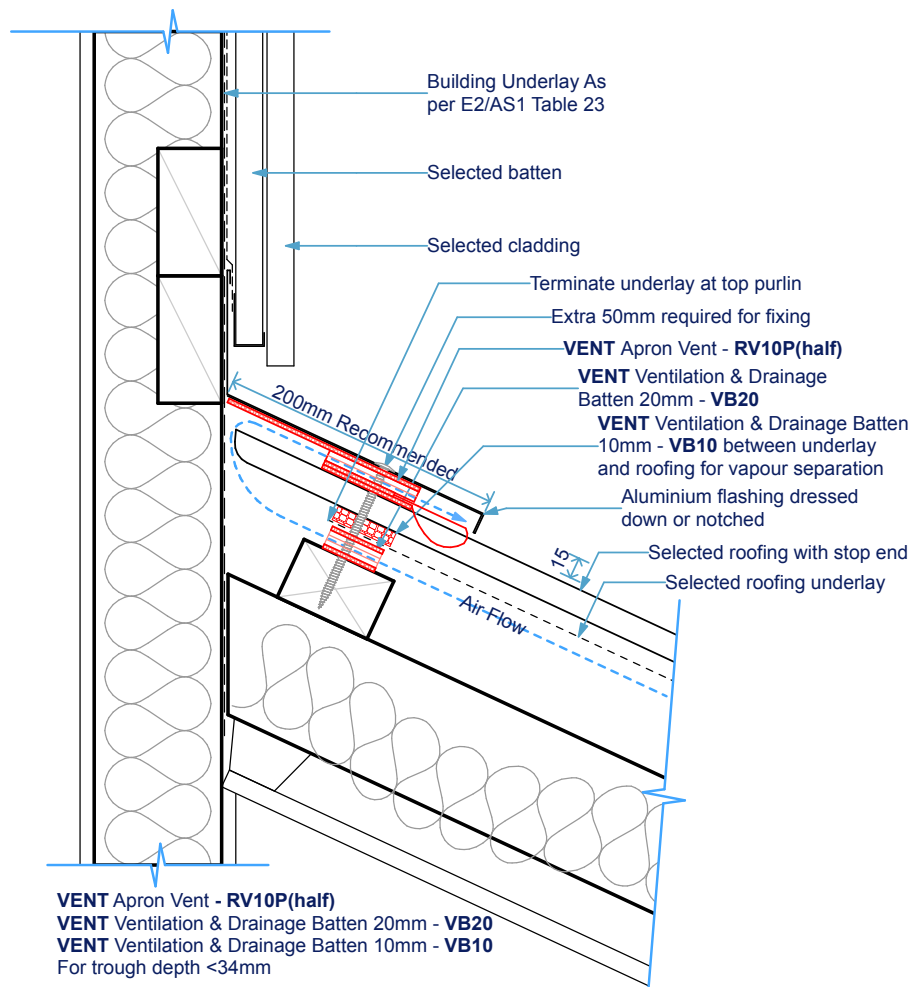

PRODUCT INFORMATION SHEET



VENT APRON VENT RV10P HALF

Fig B: Skillion Roof Barge Application

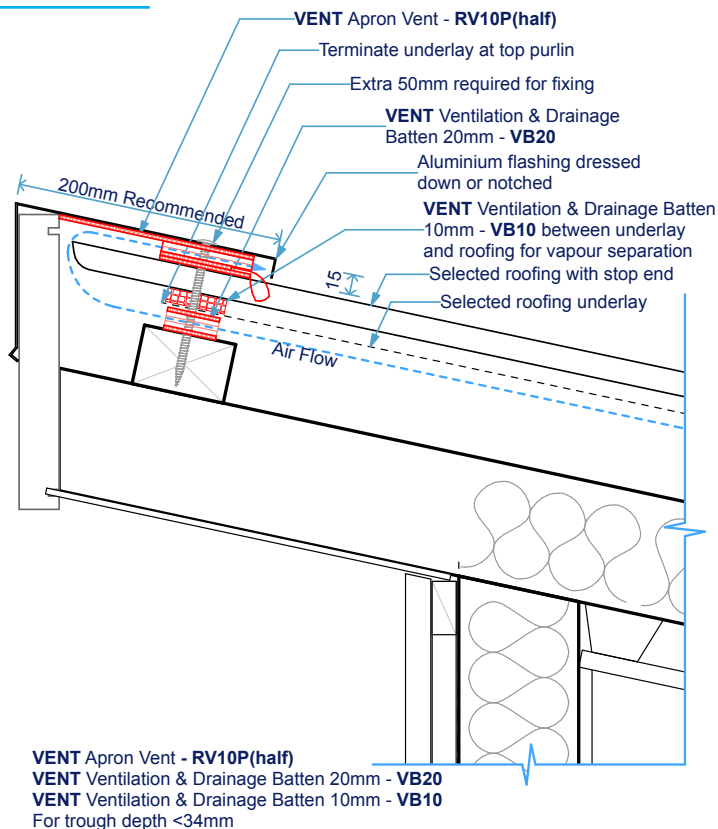

PROFILED STEEL ROOF CLADDING
 Ventilated Ridge Barge Detail - Skillion Roof

Fig C: Dimensions

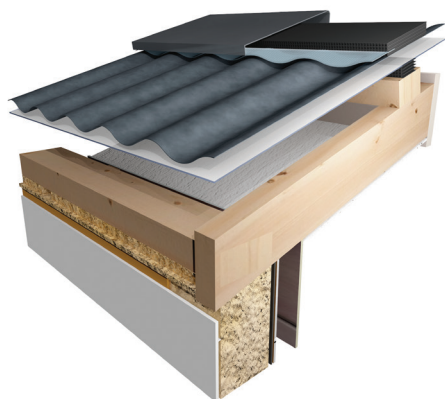
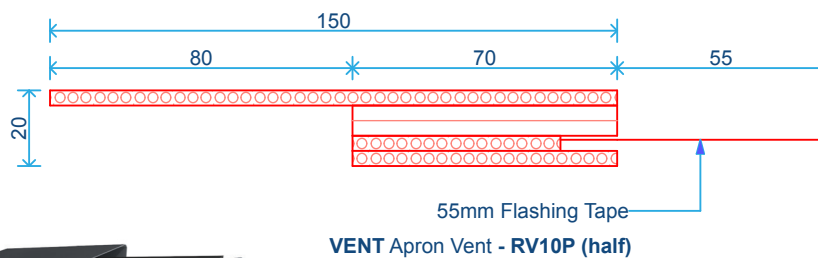

PRODUCT INFORMATION SHEET



Note: Diagrams are for guidance purposes only. The overall design is the responsibility of the designer as there are often other factors to consider. The company maintains a policy of continuous development of its product range and reserves the right to amend the specification without notice.