

VENT Over Fascia Vent - G2500N

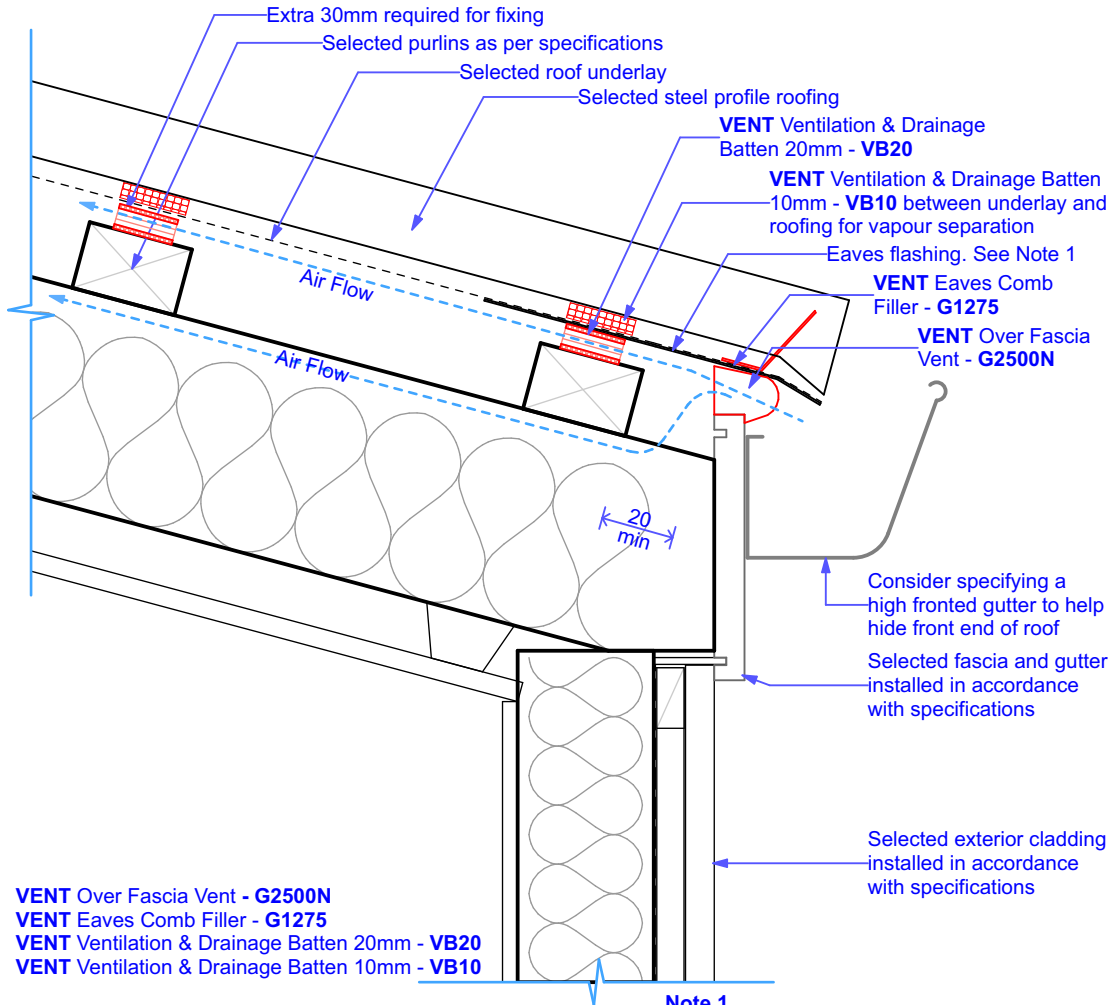

- VENT Over Fascia Vent - G2500N**
- VENT Eaves Comb Filler - G1275**
- VENT Ventilation & Drainage Batten 20mm - VB20**
- VENT Ventilation & Drainage Batten 10mm - VB10**

PROFILED STEEL ROOF CLADDING
 Ventilated Fascia - Skillion Roof No Eave
 (25,000mm² lin/m)

A minimum of 20mm gap between the bottom purlin and Over Fascia Vent must be maintained to allow air flow into roof cavity

Note 1
 Eave flashing required where all of the following conditions are met
 - Roof pitch less than 10° and,
 - Soffit width less than or equal to 100mm and,
 - Wind zone is Very High or greater.

THIS IS A SUGGESTED METHOD OF VENTILATION BUT THE OVERALL DESIGN AND DIMENSIONS ARE THE RESPONSABILITY OF THE DESIGNER IN COMPLIANCE WITH THE NZ BUILDING CODE.

Figure 15
Steel Longrun Any Pitch - Skillion Roof
No Eave
Eave - G2500N + VB20 + VB10 + G1275
Scale 1:5, 1:2

Contact:
 PH: 07 574 1116
 EM: info@vent.nz

