

VENT EAVES COMB FILLER G1275

DESCRIPTION

The VENT Eaves Comb Filler G1275 is designed with flexible fingers which adjust to fill the gaps left when using profiled tiles or steel roof cladding. This prevents entry by birds and large insects beneath the tiles.

FEATURES

- More cost effective than using purpose made fillers.
- Allows air to flow through the roofing profiles between the roof and membrane/underlay reducing dew point transfer.
- Profiles to the underside of the roof covering.
- 1m Lengths for ease of installation.
- Prevents ingress of nesting birds.

SCOPE OF USE

- Commercial and residential application.
- Suitable for use on all roof types.

WARRANTY

- 15 years

MAINTENANCE

- No maintenance requirements.

SPECIFICATIONS

| | |
|-----------------------|----------------------------------------|
| Colours | Black |
| Packing details | 50 Meters - 50x1 Meter lengths per box |
| Weight | 4g per box |
| Material | Polyethylene |
| Manufacturing process | Injection moulded |

STORAGE

Handling and storage of VENT Roof Ventilation Products, whether on-site or off-site, is under the control of the building contractor. Roof Ventilation Products must be protected from direct sunlight and physical damage, and should be stored flat and under cover.

VENT Eaves Comb Filler G1275



VENT Eaves Comb Filler G1275 with VENT Over Fascia Vent G1200N



VENT EAVES COMB FILLER G1275

INSTALLATION

1. The G1275 Eaves Comb Filler should be nailed or screwed to the top of the fascia board or over-fascia vent through the fixing holes provided along the full length of the eaves and joined where necessary.
2. It can be fixed over a paper support tray if required.
3. Confirm with fascia manufacture correct screw fixings to ensure fascia warranties are upheld.
4. For metal fascias Armagalv screws are recommended.
5. The VENT Eaves Comb Filler should not be exposed to direct sunlight for more than 30 days.

Figure A: G1275 Eaves Comb Filler. Installed with Over Fascia Vents

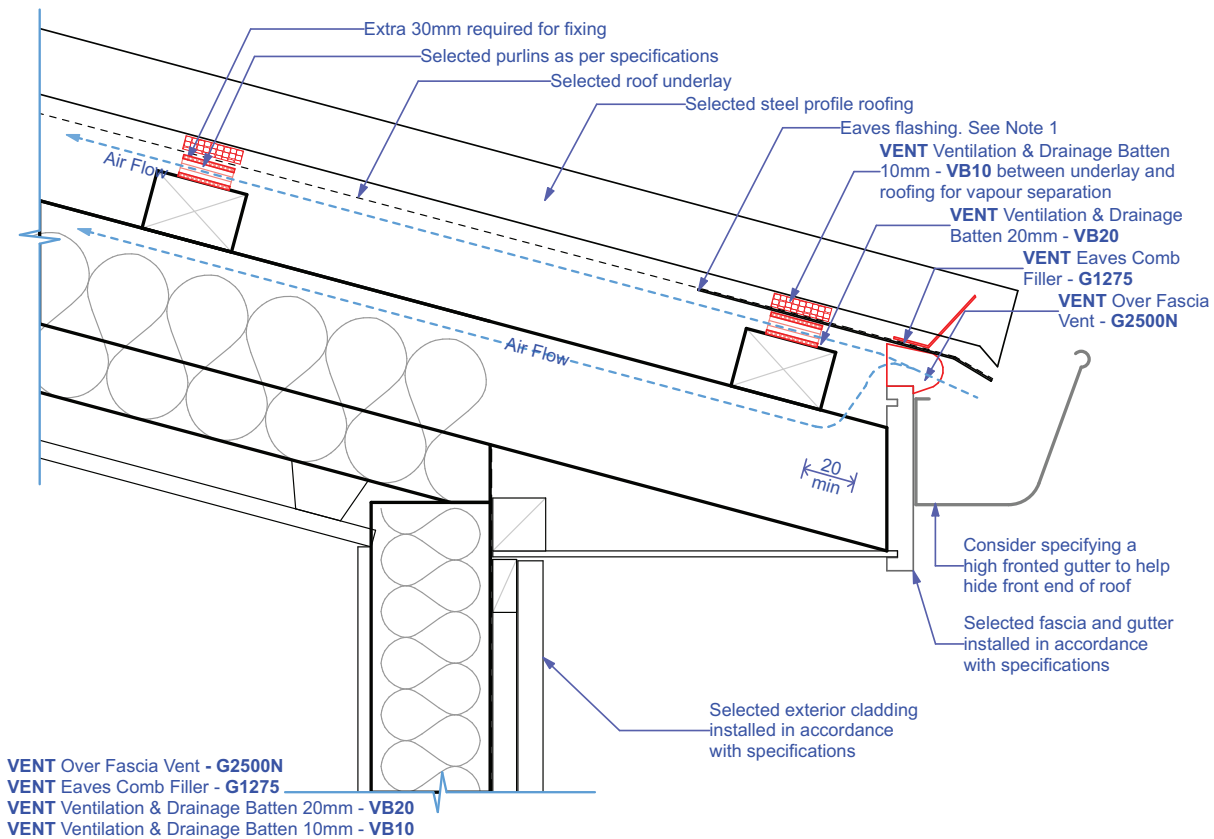

Note: Diagrams are for guidance purposes only. The overall design is the responsibility of the designer as there are often other factors to consider. The company maintains a policy of continuous development of its product range and reserves the right to amend the specification without notice.